

Level One and Two

Level One

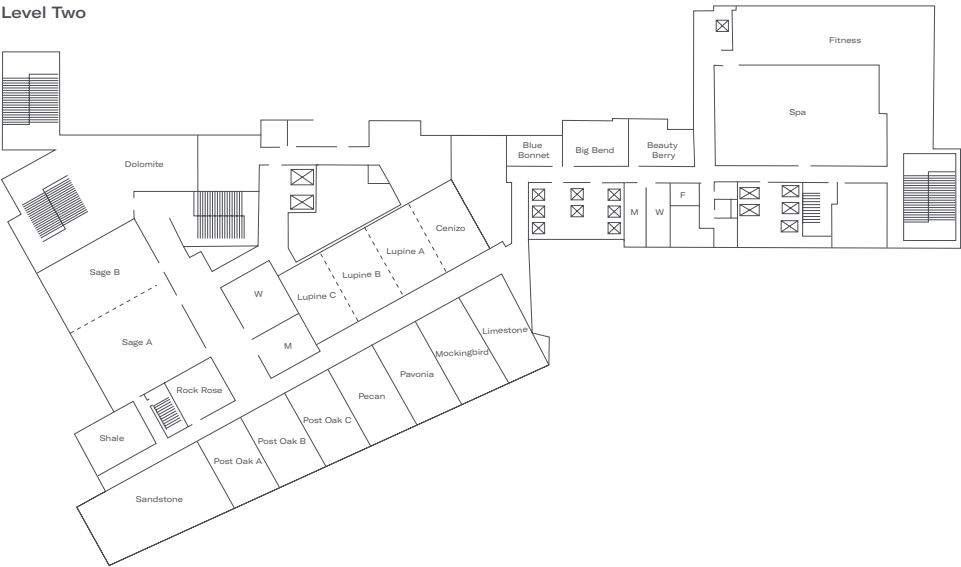

Level Two



Venue	Dimensions (Ft.)	Sq. Ft.	Ceiling (Ft.)	Classroom	Banquet	Reception	Theater	U-Shape	Conference	Exhibits 10 × 10
Lower Level										
Front Row Lawn		27,228		1,815	2,269	2,723	3,025	778	648	136
Exhibition Hall 1		21,800	9'-11'	1,453	1,817	2,180	2,422	623	519	109
Exhibition Hall 2		21,469	9'-11'	1,431	1,789	2,147	2,385	613	511	107
Total Exhibition Hall		43,269		2,885	3,606	4,327	4,808	1,236	1,030	216
Total Lower Level		70,497		4,700	5,875	7,050	7,833	2,014	1,679	352
Level One										
Honor Ballroom A	62'-2" × 70'-3"	4,371	27'	291	364	437	486	125	104	22
Honor Ballroom B	62'-2" × 35'-2"	2,185	27'	146	182	219	243	62	52	11
Honor Ballroom C	61'-10" × 105'-9"	6,547	27'	436	546	655	727	187	156	33
Honor Ballroom D	62'-7" × 35'-7"	2,182	27'	145	182	218	242	62	52	11
Honor Ballroom E	62'-7" × 35'-7"	2,182	27'	145	182	218	242	62	52	11
Honor Ballroom F	62'-7" × 35'-7"	2,182	27'	145	182	218	242	62	52	11
Total Honor Ballroom		19,649		1,310	1,637	1,965	2,183	561	468	98
Monument Ballroom A	57'-7" × 40'-6"	2,333	27'	156	194	233	259	67	56	12
Monument Ballroom B	57'-7" × 40'-6"	2,333	27'	156	194	233	259	67	56	12
Monument Ballroom C	57'-7" × 40'-6"	2,333	27'	156	194	233	259	67	56	12
Monument Ballroom D	57'-11" × 121'-6"	7,008	27'	467	584	701	779	200	167	35
Monument Ballroom E	57'-11" × 121'-6"	7,008	27'	467	584	701	779	200	167	35
Monument Ballroom F	57'-7" × 40'-6"	2,333	27'	156	194	233	259	67	56	12
Monument Ballroom G	57'-7" × 40'-6"	2,333	27'	156	194	233	259	67	56	12
Monument Ballroom H	57'-7" × 40'-6"	2,333	27'	156	194	233	259	67	56	12
Total Monument Ballroom		28,014		1,868	2,335	2,801	3,113	800	667	140
Total Level One		47,663		3,178	3,972	4,766	5,296	1,362	1,135	238
Level Two										
Beautyberry	32'-4" × 19'-5"	626	13' 4"	42	52	63	70	18	15	3
Big Bend	32'-4" × 20'-2"	651	13' 4"	43	54	65	72	19	16	3
Bluebonnet	26'-9" × 14'-3"	372	13' 4"	25	31	37	41	11	9	2
Cenizo	24'-9" × 41'-1"	1,017	13' 4"	68	85	102	113	29	24	5
Dolomite	62'-0" × 35'-2"	2,177	13' 4"	145	181	218	242	62	52	11
Limestone	40'-6" × 25'	1,013	13' 4"	68	84	101	113	29	24	5
Lupine A	25' × 41'-2"	1,032	13' 4"	69	86	103	115	29	25	5
Lupine B	25' × 41'-2"	1,032	13' 4"	69	86	103	115	29	25	5
Lupine C	24' × 41'-2"	1,020	13' 4"	68	85	102	113	29	24	5
Mockingbird	44'-4" × 25'	1,108	13' 4"	74	92	111	123	32	26	6
Pavonia	42'-5" × 25'	1,061	13' 4"	71	88	106	118	30	25	5
Pecan	40'-6" × 25'	1,012	13' 4"	67	84	101	112	29	24	5
Post Oak A	34'-9" × 25'	868	13' 4"	58	72	87	96	25	21	4
Post Oak B	36'-6" × 25'	913	13' 4"	61	76	91	101	26	22	5
Post Oak C	38'-7" × 25'	965	13' 4"	64	80	97	107	28	23	5
Rock Rose	26' × 23'-7"	616	13' 4"	41	51	62	68	18	15	3
Sage A	57' × 46'-0"	2,398	13' 4"	160	200	240	266	69	57	12
Sage B	57' × 36'-0"	1,860	13' 4"	124	155	186	207	53	44	9
Sandstone	68'-6" × 32'-6"	2,228	13' 4"	149	186	223	248	64	53	11
Shale	30'-3" × 24'	728	13' 4"	49	61	73	81	21	17	4
Total Level Two		22,697		1,513	1,891	2,270	2,522	648	540	113

Level Three and Four

Level Three

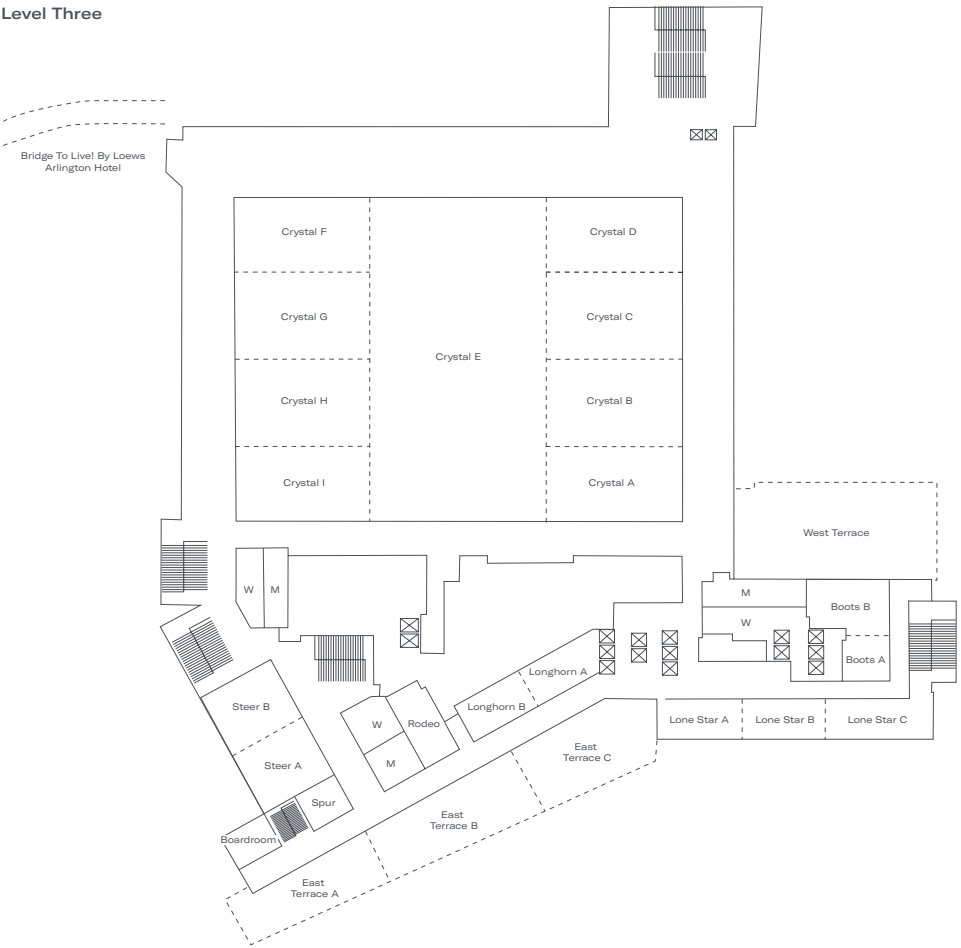

Level Four

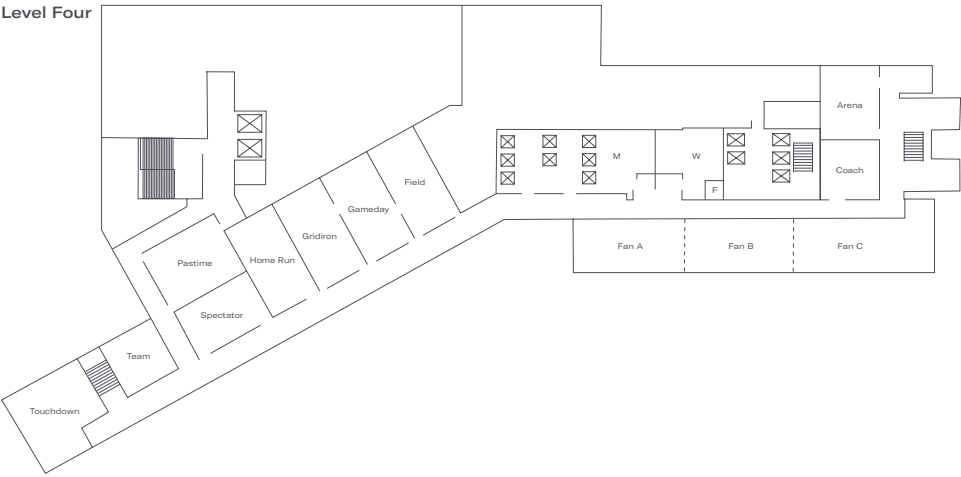

Venue	Dimensions (Ft.)	Sq. Ft.	Ceiling (Ft.)	Classroom	Banquet	Reception	Theater	U-Shape	Conference	Exhibits 10 x 10
Level Three Exterior Event Terrace										
West Terrace	104' x 56' 2"	5,808		387	484	581				
East Terrace A	33' x 75'	2,811	27'	160	200	240				
East Terrace B	36' x 82'	2,973	27'	170	213	255				
East Terrace C	39' x 96'	4,229	27'	105	132	158				
Total Event Terrace		12,848		950	1,188	1,425				

Venue	Dimensions (Ft.)	Sq. Ft.	Ceiling (Ft.)	Classroom	Banquet	Reception	Theater	U-Shape	Conference	Exhibits 10 × 10
Level Three										
Crystal Ballroom A	74' 4" × 45' 6"	3,525	23'	235	294	353	392	101	84	18
Crystal Ballroom B	74' 4" × 52' 6"	4,087	23'	272	341	409	454	117	97	20
Crystal Ballroom C	74' 4" × 52' 6"	4,087	23'	272	341	409	454	117	97	20
Crystal Ballroom D	74' 4" × 45' 6"	3,525	23'	235	294	353	392	101	84	18
Crystal Ballroom E	196' × 106'	20,776	23'	1,385	1,731	2,078	2,308	594	495	104
Crystal Ballroom F	74' 4" × 45' 6"	3,525	23'	235	294	353	392	101	84	18
Crystal Ballroom G	74' 4" × 52' 6"	4,087	23'	272	341	409	454	117	97	20
Crystal Ballroom H	74' 4" × 52' 6"	4,087	23'	272	341	409	454	117	97	20
Crystal Ballroom I	74' 4" × 45' 6"	3,525	23'	235	294	353	392	101	84	18
Total Crystal Ballroom		51,224		3,415	4,269	5,122	5,692	1,464	1,220	256
Boardroom									16	
Boots A	28' × 26'	663	13' 4"	44	55	66	74	19	16	3
Boots B	49' 1 × 26'	1,435	13' 4"	96	120	144	159	41	34	7
Lone Star A	51' × 23'	1,104	13' 4"	74	92	110	123	32	26	6
Lone Star B	50' × 23'	1,075	13' 4"	72	90	108	119	31	26	5
Lone Star C	64' × 23'	1,542	13' 4"	103	129	154	171	44	37	8
Longhorn A	47' × 20' 6"	970	13' 4"	65	81	97	108	28	23	5
Longhorn B	43' × 20' 6"	853	13' 4"	57	71	85	95	24	20	4
Rodeo	45' 4" × 23'	1,045	13' 4"	70	87	105	116	30	25	5
Spur	23' × 21' 3"	490	13' 4"	33	41	49	54	14	12	2
Steer A	43' × 39'	1,634	13' 4"	109	136	163	182	47	39	8
Steer B	43' × 39'2"	1,680	13' 4"	112	140	168	187	48	40	8
Total Meeting Rooms		13,158		877	1,097	1,316	1,462	376	313	66
Total Level Three		78,634		5,242	6,553	7,863	8,737	2,247	1,872	393
Level Four										
Arena	33' × 25'	1,193	13' 4"	80	99	119	133	34	28	6
Coach	25' 6" × 25'	1,037	13' 4"	69	86	104	115	30	25	5
Fan A	50' × 24'	1,086	13' 4"	72	91	109	121	31	26	5
Fan B	48' × 24'	1,047	13' 4"	70	87	105	116	30	25	5
Fan C	67' × 24'	1,047	13' 4"	70	87	105	116	30	25	5
Field	45' × 23' 4"	824	13' 4"	55	69	82	92	24	20	4
Gameday	45' × 24'	1,051	13' 4"	70	88	105	117	30	25	5
Gridiron	45' × 24'	639	13' 4"	43	53	64	71	18	15	3
Home Run	45' × 24' 6"	825	13' 4"	55	69	83	92	24	20	4
Pastime	36' × 29'	1,630	13' 4"	109	136	163	181	47	39	8
Spectator	36' × 23'	640	13' 4"	43	53	64	71	18	15	3
Team	29' × 25'	1,155	13' 4"	77	96	116	128	33	28	6
Touchdown	39' × 24' 8"	1,347	13' 4"	90	112	135	150	38	32	7
Total Level Four		13,943		930	1,162	1,394	1,549	398	332	70